

# Aesculap – The Instrument Manufactory

Instruments & Process Solutions in Orthopaedics



Aesculap Orthopaedics

# Aesculap – The Instrument Manufactory

Almost 150 years of Experience.

The Origin of Aesculap lies in the development and manufacturing of surgical instruments for medical applications. We apply 150 years of experience and knowledge to design and develop new instruments and process solutions for today's requirements. This will allow you to reap significant benefits in your daily practice.

A special challenge of today is represented by the impact of the surgical instrumentation in the balance between economics, treatment quality, outcome and modern operating techniques and processes. Aesculap has undertaken the task of optimization of the entire instrument cycle and directed its focus on the economic and functional aspects of the entire process.





# Aesculap® IQ Instrument Platform

Tangible Benefits.

Safe and correct assembly.

Routine processes are facilitated by uniform handles, coupling and colour coding:

- Femur (red)
- Tibia (blue)
- General instruments (yellow)

Addressing of different philosophies, e.g Tibia or Femur First, intra- or extra-medullary orientation, minimal invasion or standard access.

## Intuitive & Quick

Under this theme, the new IQ instrument platform for Aesculap® knee systems was developed by Aesculap. The IQ platform offers functionality, precision, ergonomics and efficiency in the OR.



The reduction of the instrument volume leads to a higher work efficiency in the operating room as also in the preparation.

Reduction of OR-steps via simplified and reduced instrumentation.

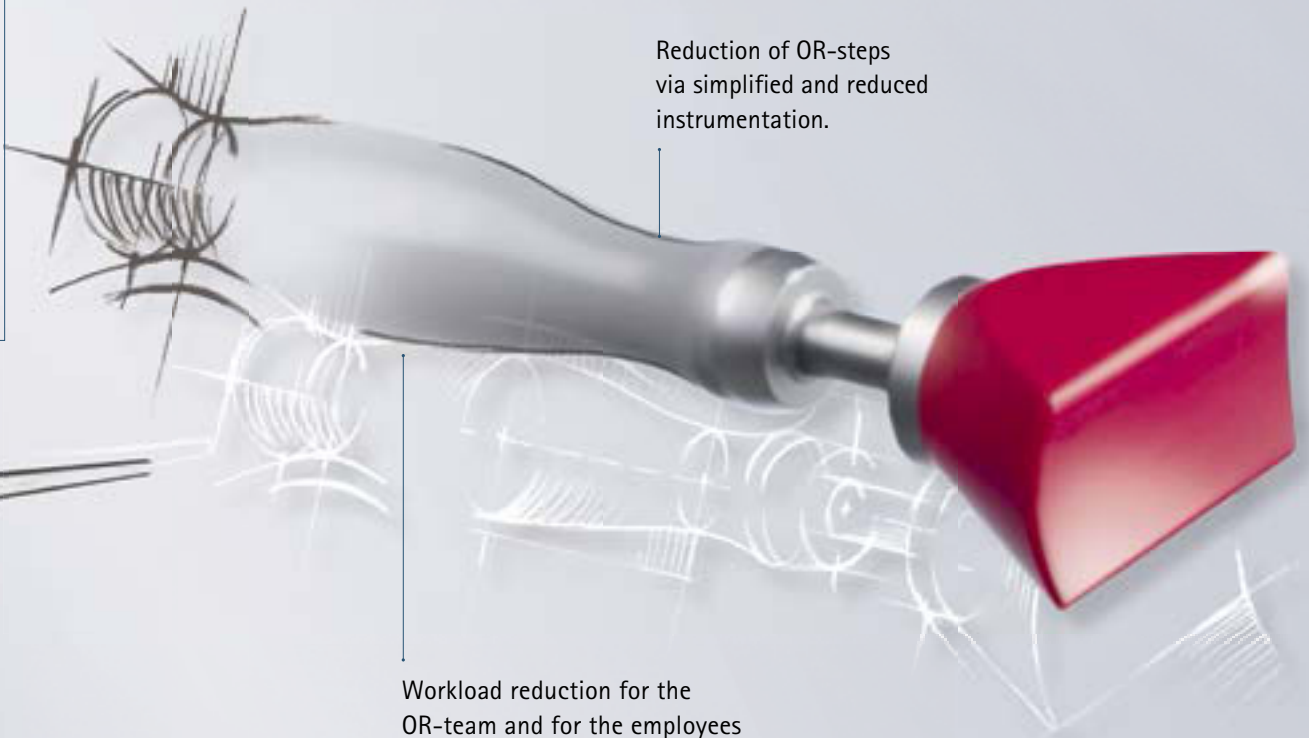

Workload reduction for the OR-team and for the employees in the CSSD (Central Sterilisation and Storage Department) via lower modularity and through instruments that are easy to handle.

# Aesculap® OrthoTray®

Efficiency in the Process.

## Aesculap® OrthoTray®

The new Aesculap® instrument storage system is designed to improve efficiency of the entire instrument cycle. This is possible due to the specially designed cleaning friendly IQ instrumentation which has been fully validated for us in the new washing and reprocessing system. The instruments can remain within the storage after the pre-cleaning for the entire preparation process. Work steps such as re-packaging of the instruments after the washing process, are omitted. Packaged in the Aesculap® sterile container, Aesculap® OrthoTray®s can be transported and stored maintaining sterility.

The Aesculap® OrthoTray® can be used as validated washing system together with the IQ instruments.

The large perforation of the Aesculap® OrthoTray®s enables a good water flow.

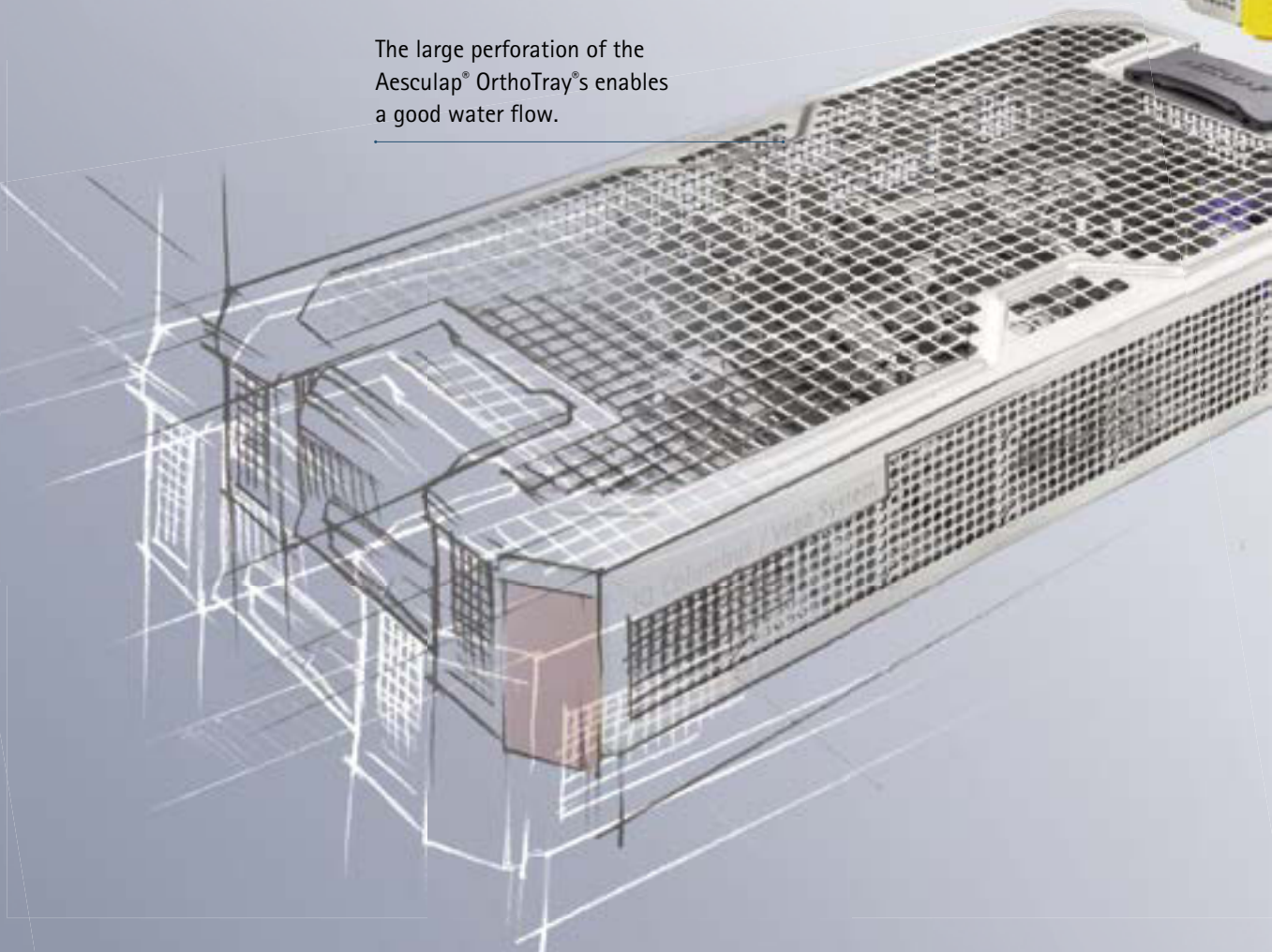



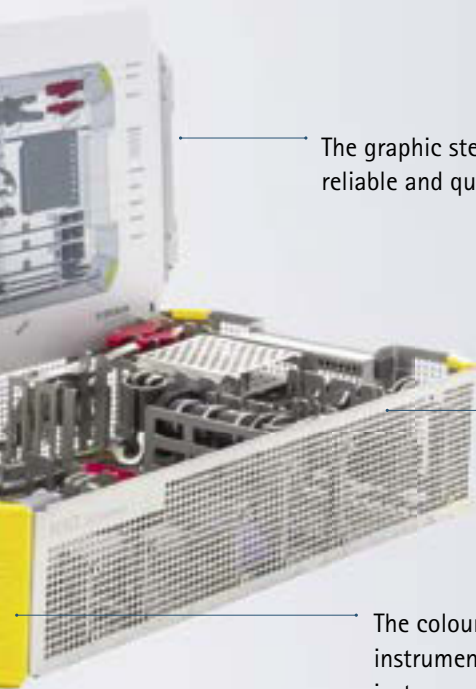

The graphic stencil enables reliable and quick packaging.

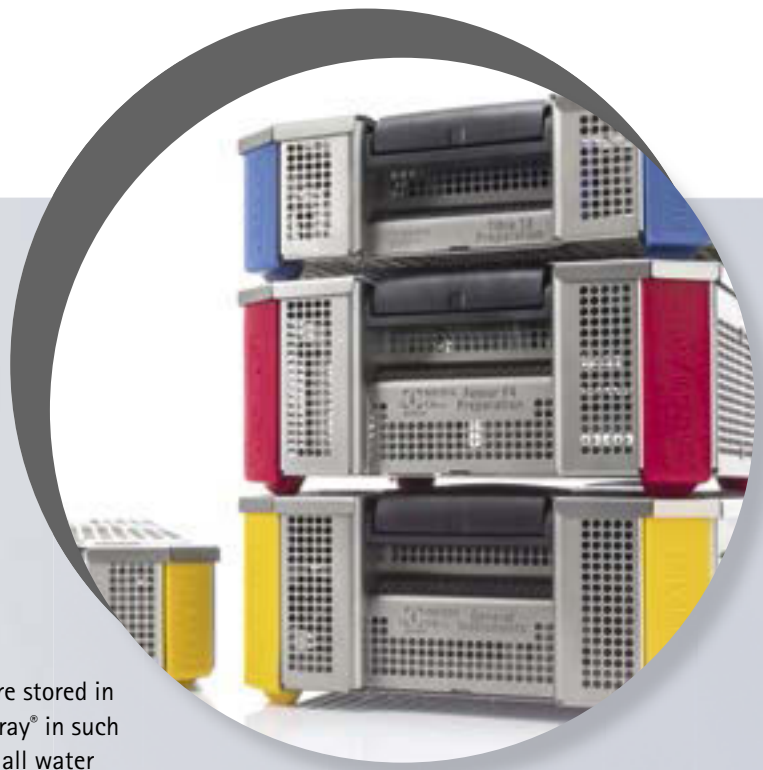

The IQ instruments are stored in the Aesculap® OrthoTray® in such a way to ensure that all water drained in a proper manner.

The colour coding on the tray and the instruments simplifies orientation of instruments and packaging.



Ergonomic closure elements facilitate carrying and prevent an unwanted opening.



# Aesculap® RESET®

Less is more.

Cost reduction potentials of over 30% as against conventional instruments via efficient Aesculap® RESET®-solution.

Lower risk of incomplete instrument trays.

Simplified instrumentation and reprocessing due to better overview.

The size-specific configuration reduces the instrument and tray volumes over the entire instrument cycle.

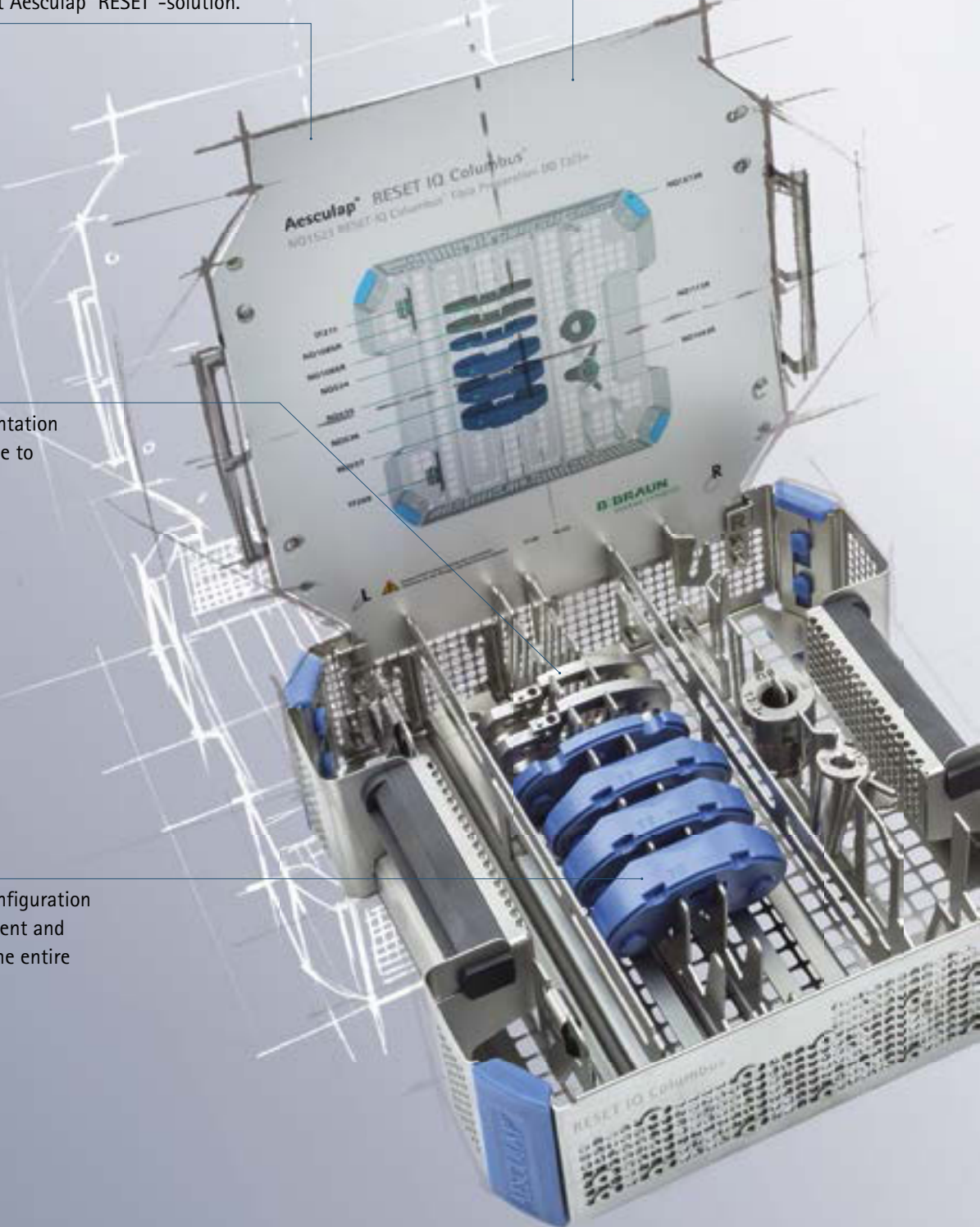



## Aesculap® RESET®

Aesculap® RESET® is an intelligent improvement of the Aesculap® OrthoTray® configuration. All size-specific instruments are packed such that only the sizes desired by the surgeon are used. Thus, the instrument and tray volumes in the entire instrument cycle are reduced by up to 50%. Aesculap facilitates, as size-specific storage and washing system, the work of all the participants in the entire process.

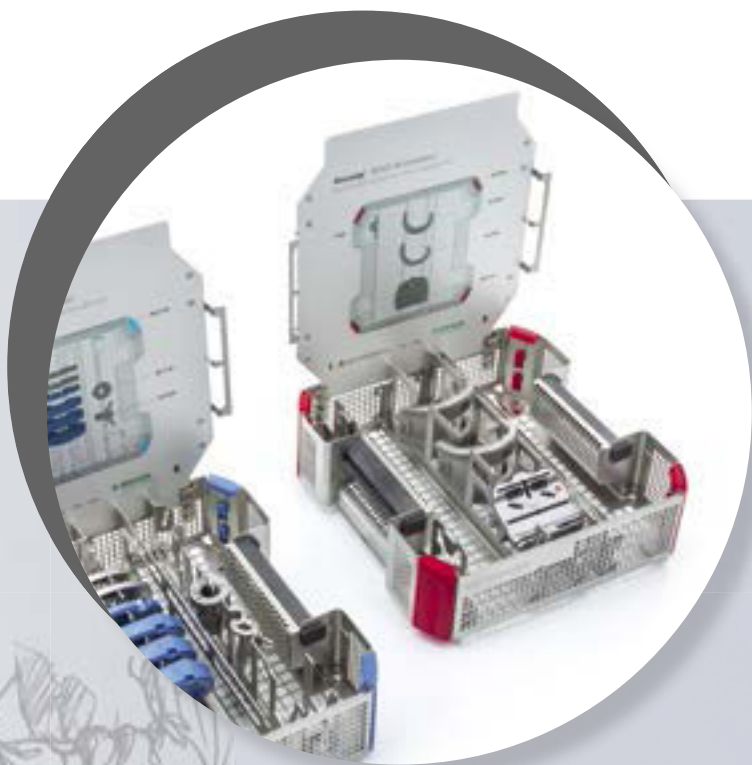

# Aesculap® Imprint

Individually aligned.

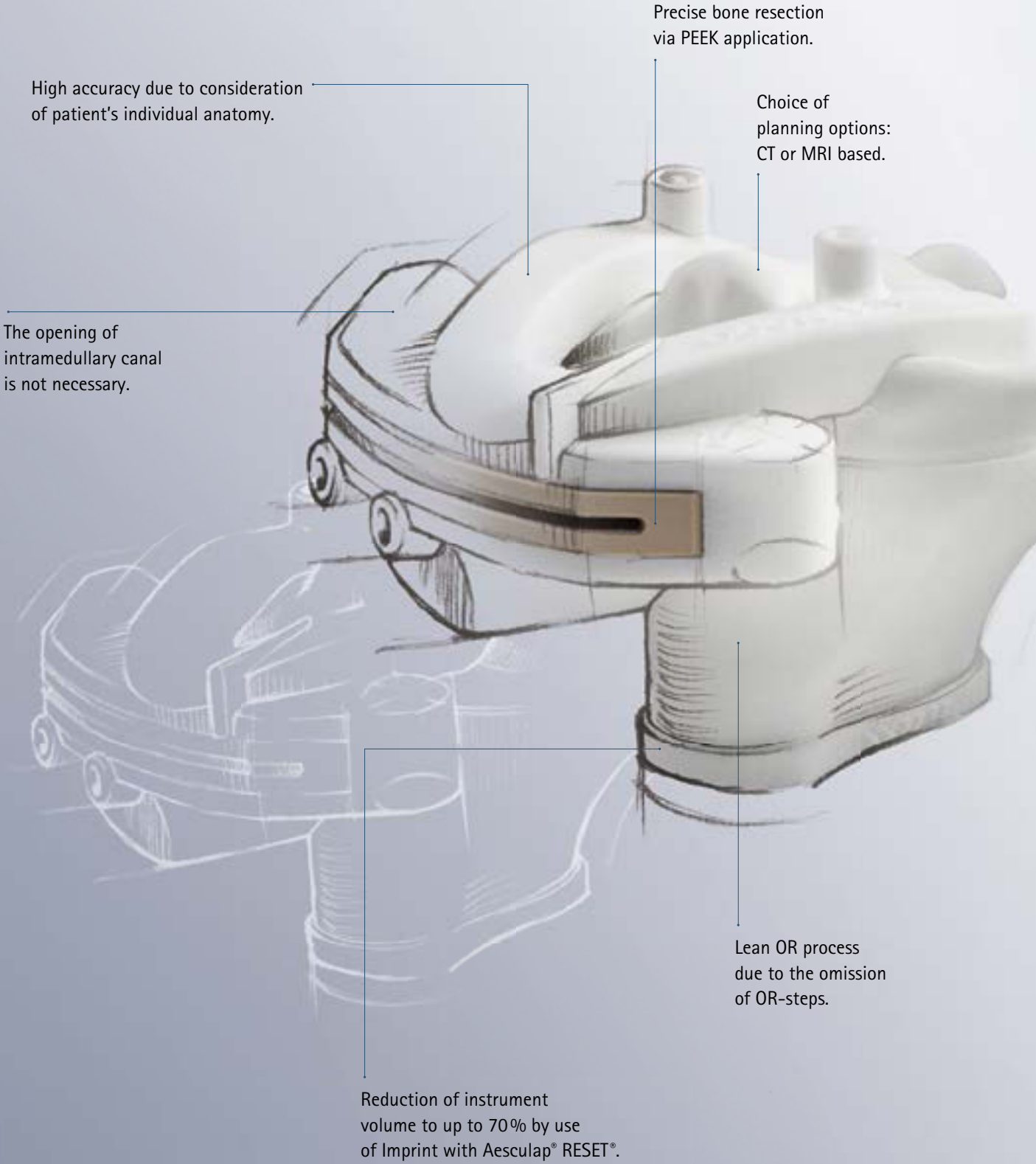

## Imprint

The patient-specific cutting blocks are aligned on the basis of CT/MRI data in the pre-operative phase as per the individual anatomy of the patient. They facilitate and reduce the operative intervention for the entire OR team considerably. The 3D planning software enables the surgeon to precisely set the implant orientation and size and all resection heights taking the situation of the patient into consideration. The necessary instrument volume is reduced to up to 70% in combination with the Aesculap® RESET®-solution.

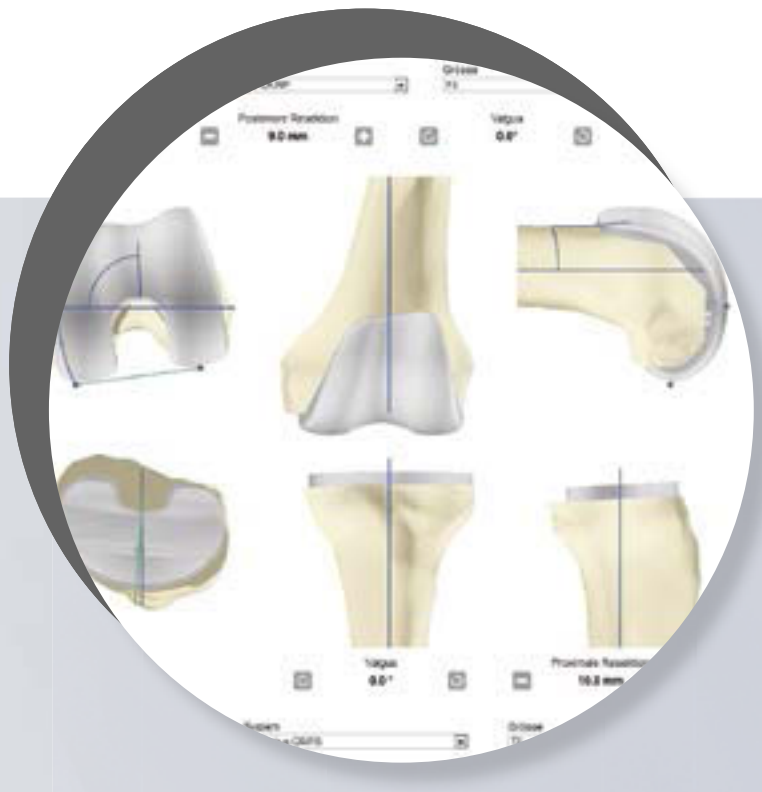



# Aesculap® OrthoPilot®

Patient specific since 1997.

## OrthoPilot®

Over 15 years of experience in navigation have shown that it is more than just a trend. It enables the intra-operative alignment of the implant position to the individual anatomy of the patient and a simulation of the result depending upon it. The patient safety is increased and the OR-process is simplified via standardised process, immediate visual feedback and the option of simulating different scenarios. The aim of the navigation is to precisely and reproducibly achieve the axis alignment, position of the joint line and the stability of the artificial knee joint desired by the surgeon.



Quality assurance by the simulation of various scenarios.

The instantaneous visual feedback means that intra-operative monitoring and adjustment is possible, in addition to post-operative process documentation.



Consideration of the individual patient anatomy without CT or MRI.

All Aesculap® knee implant and instrument systems can be used with navigation.

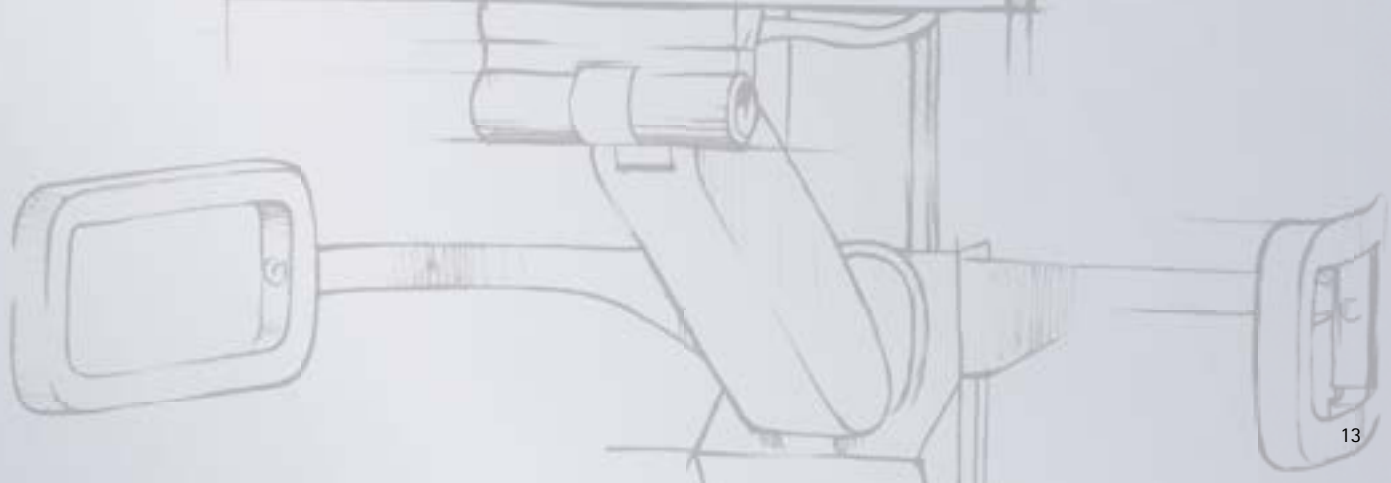

# Aesculap – The Instrument Manufactory

Instruments and Process Solutions in Orthopaedics.



Aesculap® OrthoTray®  
Efficiency in the Process.



Columbus®



OrthoPilot®  
Patient specific  
since 1997.



e.motion® Pro



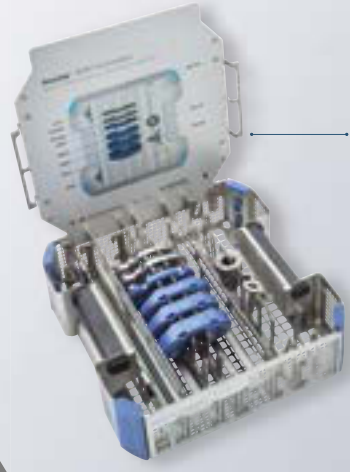

Aesculap® RESET®  
Less is more.

IQ Instrument Platform  
Tangible benefits.



VEGA System®

Inprint  
Individually aligned.



